

Poly Studio X30

See the Poly Studio X30 and Poly Studio X50 Regulatory Notices guide for all regulatory and safety guidance prior to configuration.

Avant de procéder à la configuration, veuillez consulter les Avis de réglementation du Poly Studio X30 and Poly Studio X50, afin de prendre connaissance des recommandations en matière de sécurité et de réglementation.

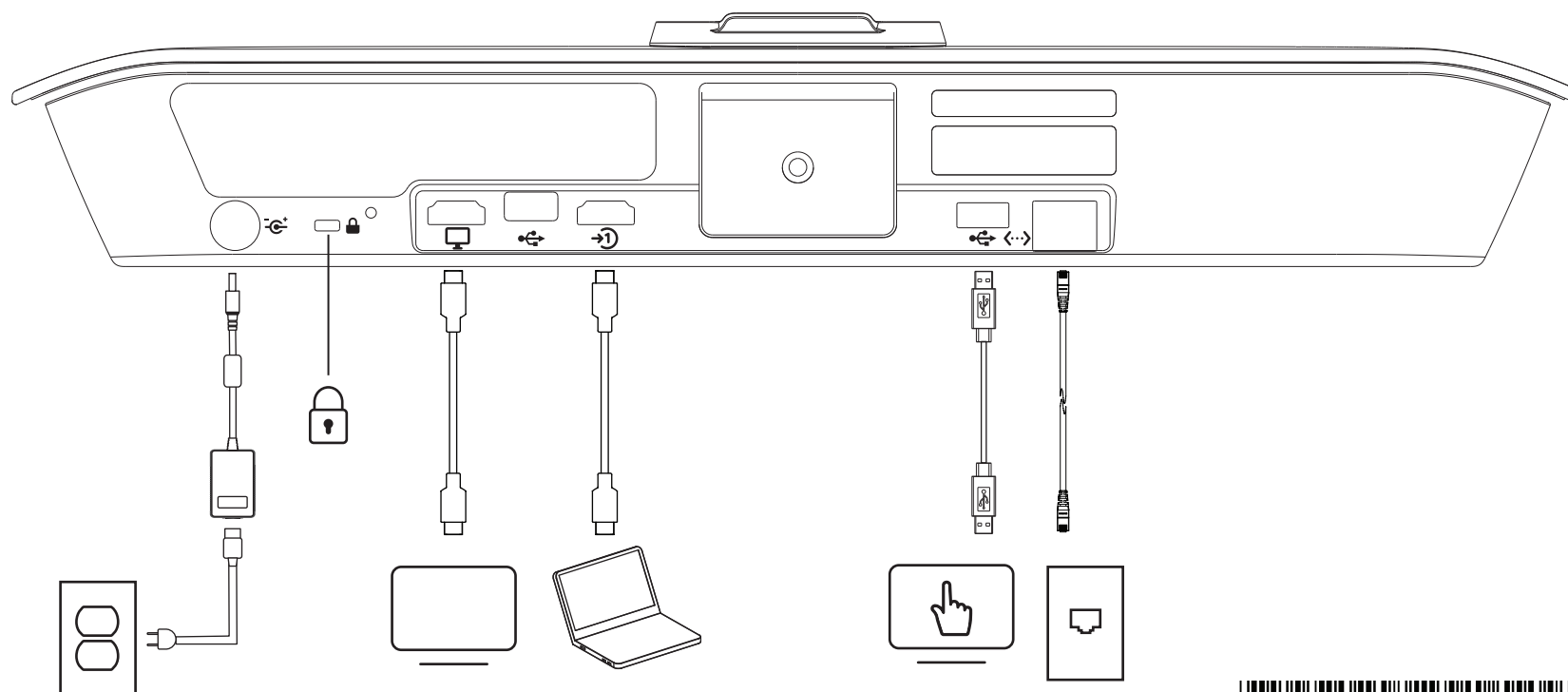

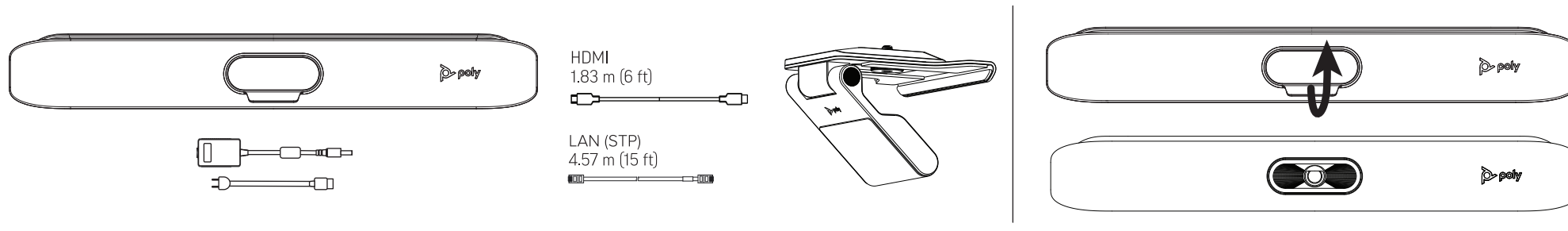
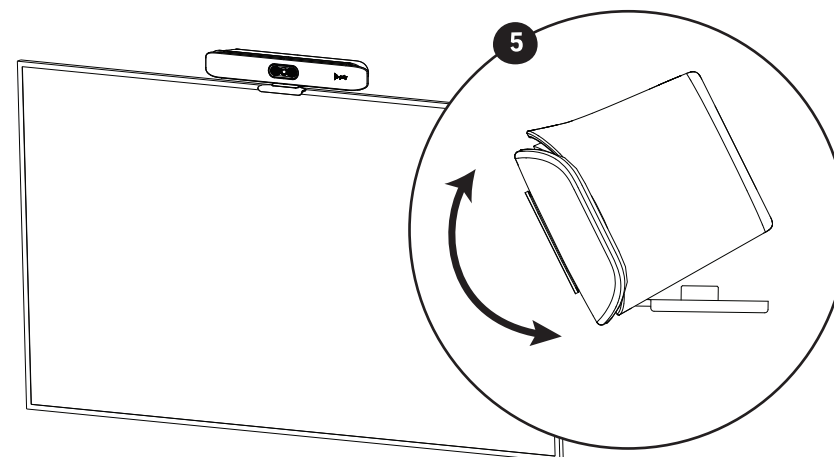
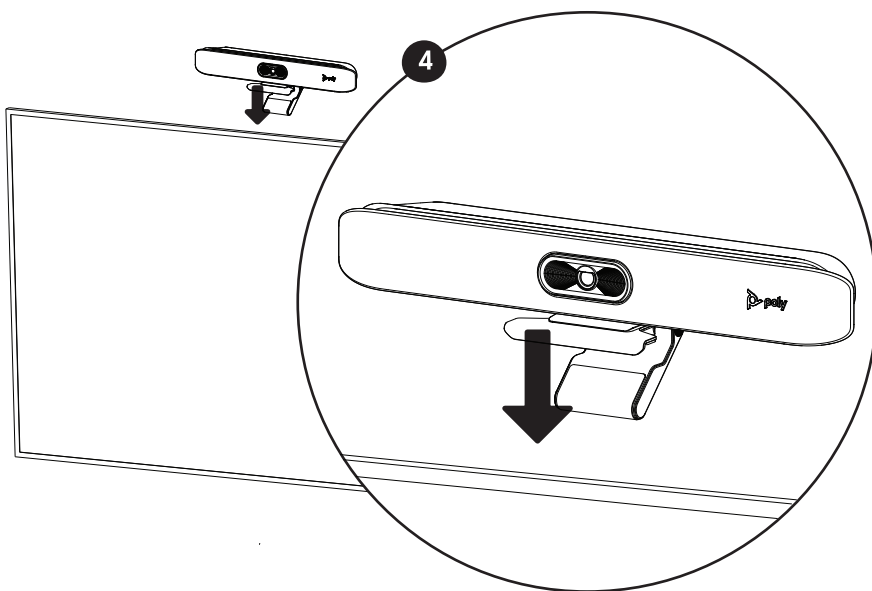
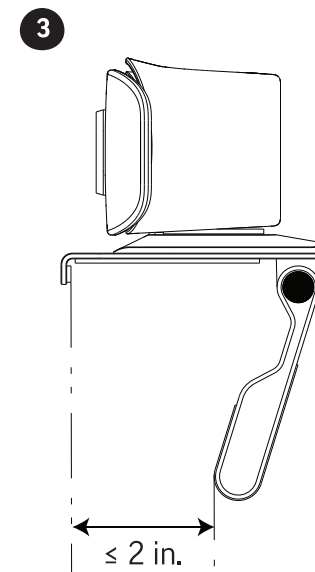
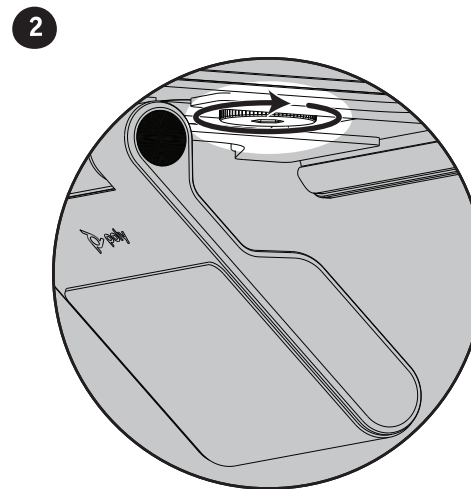
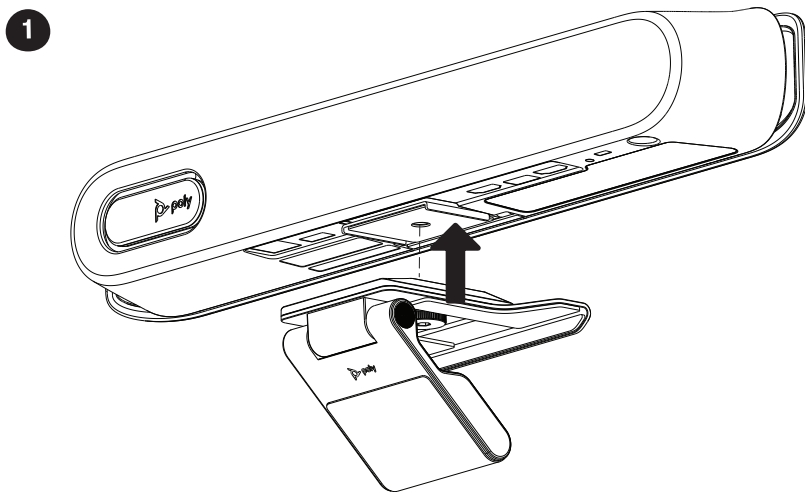

Hereby, Plantronics B.V. declares that the radio equipment type Model P018 and P017 is in compliance with Directive 2014/53/EU. The full text of the EU declaration of conformity is available at <https://support.polycom.com/video>.

| Frequency Range | Maximum Transmit Power | |
|-----------------|------------------------|----------------------|
| | P017 | P018 |
| 2422 - 2480MHz | Max EIRP [19.1] dBm | Max EIRP [18.88] dBm |
| 5150 - 5350MHz | Max EIRP [19.93] dBm | Max EIRP [20.06] dBm |
| 5470 - 5725MHz | Max EIRP [19.33] dBm | Max EIRP [19.7] dBm |

